

Top Load Auger Motor and Shields

Fig. 2-30 shows components of top load auger drive assembly. Follow Steps 1-12 to assemble.

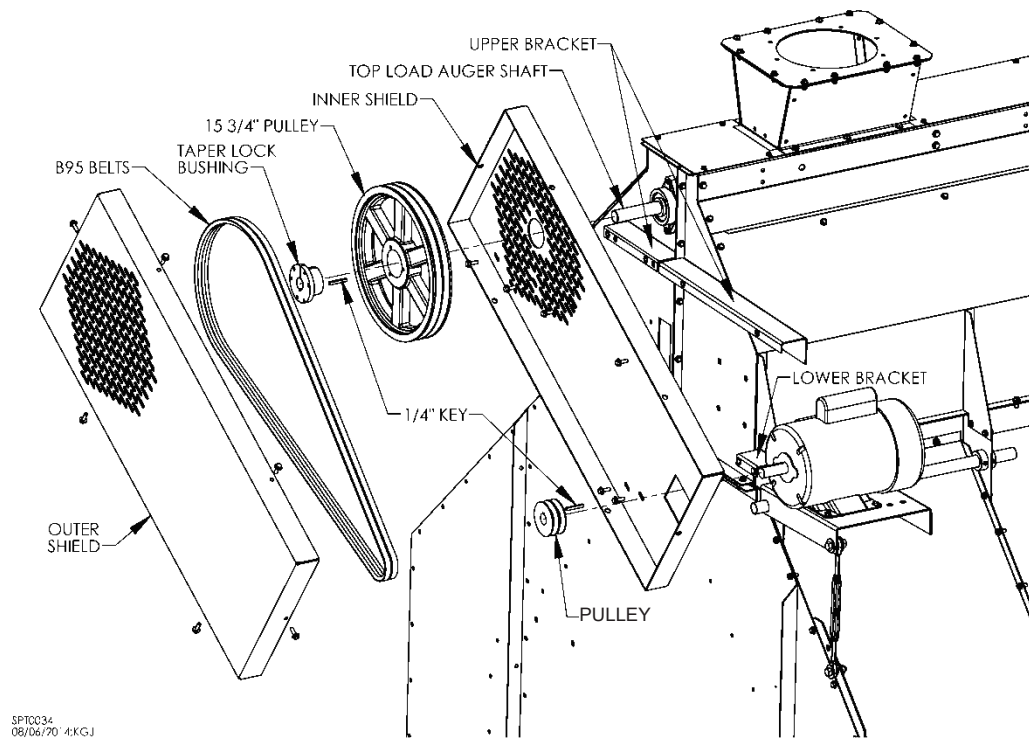

Fig. 2-30 – Top load auger components

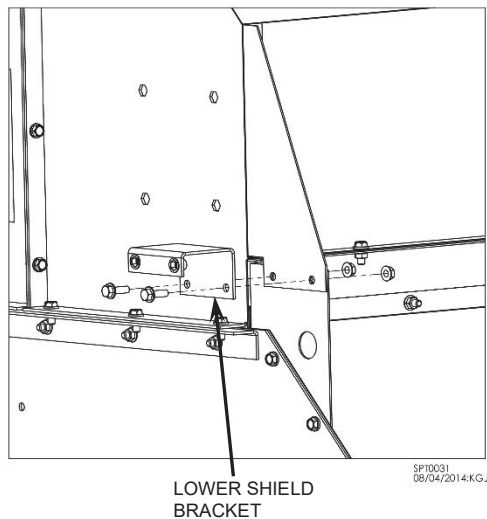
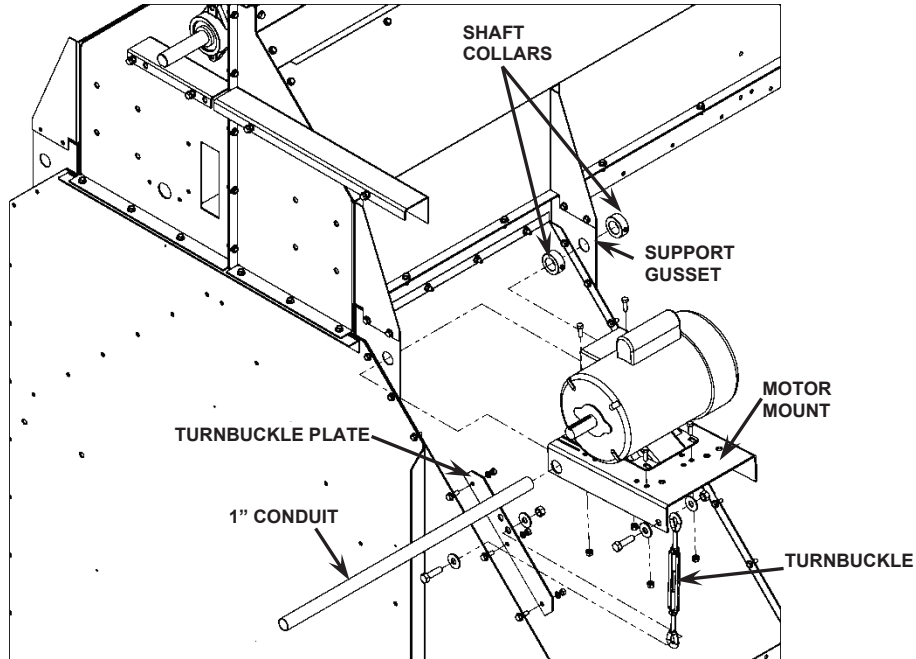

Fig. 2-31 – Lower shield bracket installation

1. Bolt lower shield bracket to end of dryer using 5/16 x 1” bolts and 5/16 nuts. See Fig. 2-31.



SP10035
06/05/20 4:KCJ

Fig. 2-32 - Motor mount components

2. Align motor mount conduit holes with holes in support gussets. Slide a 1" conduit tube through gussets and motor mount as shown in Fig. 2-32.
3. Position shaft collars on each side of gusset as shown in Fig. 2-32.
4. Tighten shaft collars on each side of gusset as shown in Image 2-5. Make sure motor mount can pivot.

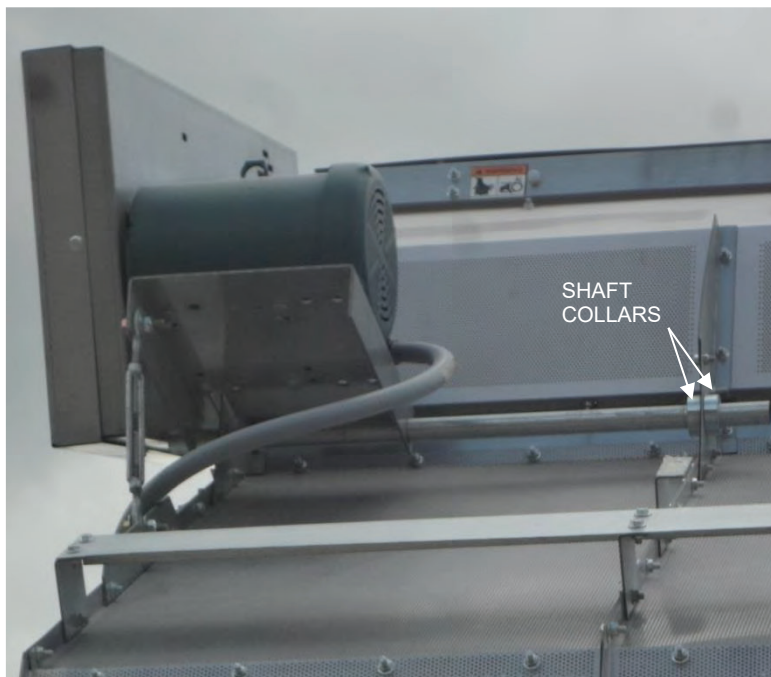

Image 2-5 – Motor mount shaft collars, installed

5. Bolt turnbuckle plate to side of dryer. See Fig. 2-32.
6. Bolt turnbuckle to motor mount and to turnbuckle plate using 1/2 x 1-3/4" bolts, 1/2" flat washers and 1/2" lock nuts. See Fig. 2-32.
7. Bolt motor to motor mount using 5/16 x 1" bolts and 5/16" nuts and washers. See Fig. 2-32.
8. Bolt inner shield to upper and lower brackets using 5/16" bolts, washers, and nuts. See Fig. 2-30.
9. Attach small pulley to motor shaft with a key and attach pulley to top load auger with a taper lock bushing. See Fig. 2-30. Use straight edge to align pulleys. Attach two B95 belts between auger pulley and motor pulley. Tighten turnbuckle to tighten belts.
Tension belts so it takes about 2.7 kg. (6 lbs.) pressure to deflect belt 1/2" at center of belt span.
10. Final assembly should appear as in Fig. 2-33 (Shown without front shield).

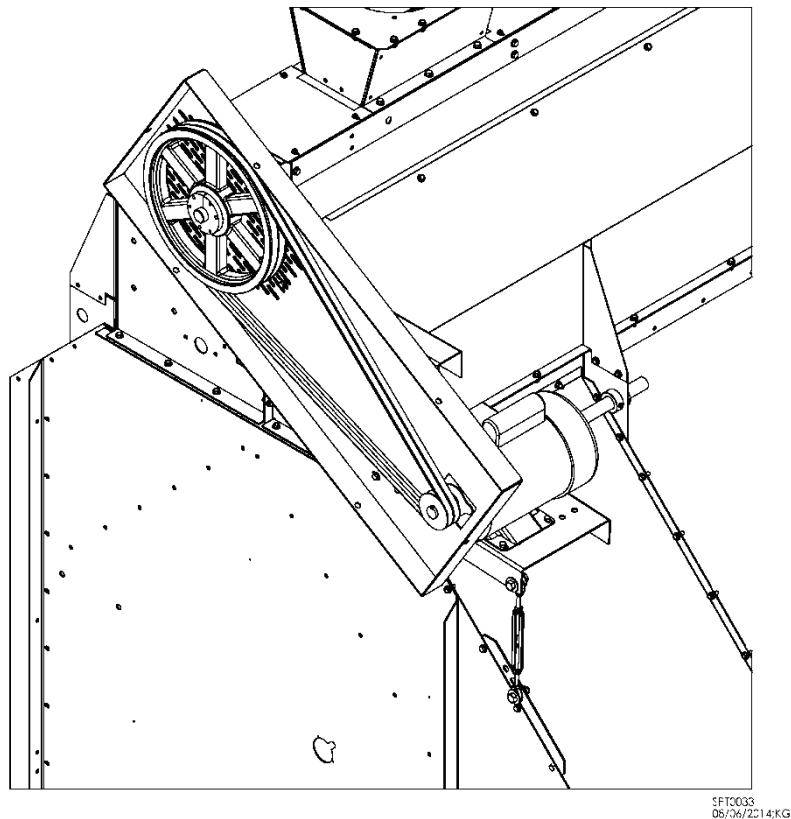
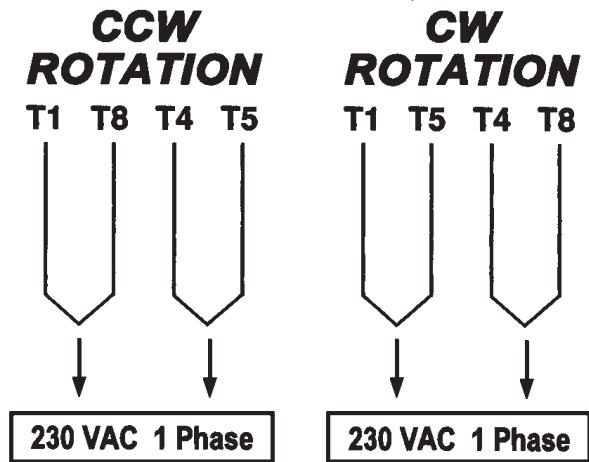

Fig. 2-33 – Final assembly (without front shield)

11. Slide outer shield around inner shield and attach with six (6) 5/16 x 1" bolts. See Fig. 2-30.
12. Check and retighten all fasteners.

Wiring Load Auger Motor



Overload circuit is intentionally disconnected in motor because overload protection (starter protector) is located in power box on dryer. A sticker, L0903, is attached to motor showing how to make wiring connections. See Fig. 2-34.

NOTE: The thermal overload device used in this motor has been disconnected. The over-current protection for motor is located in the power box.

L0903

Fig. 2-34 – Sticker L0903