

Top Load Auger Motor and Shields

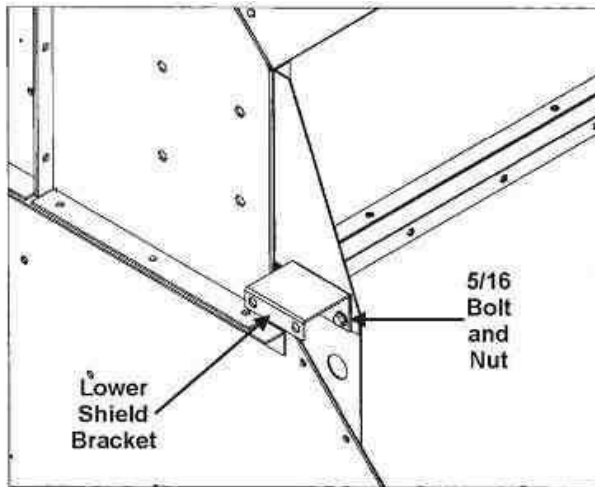

Fig. 2-14 – Lower shield bracket installation

1. Bolt lower shield bracket to end of dryer using 5/16 x 1" bolts and 5/16 nuts. See Fig. 2-14.

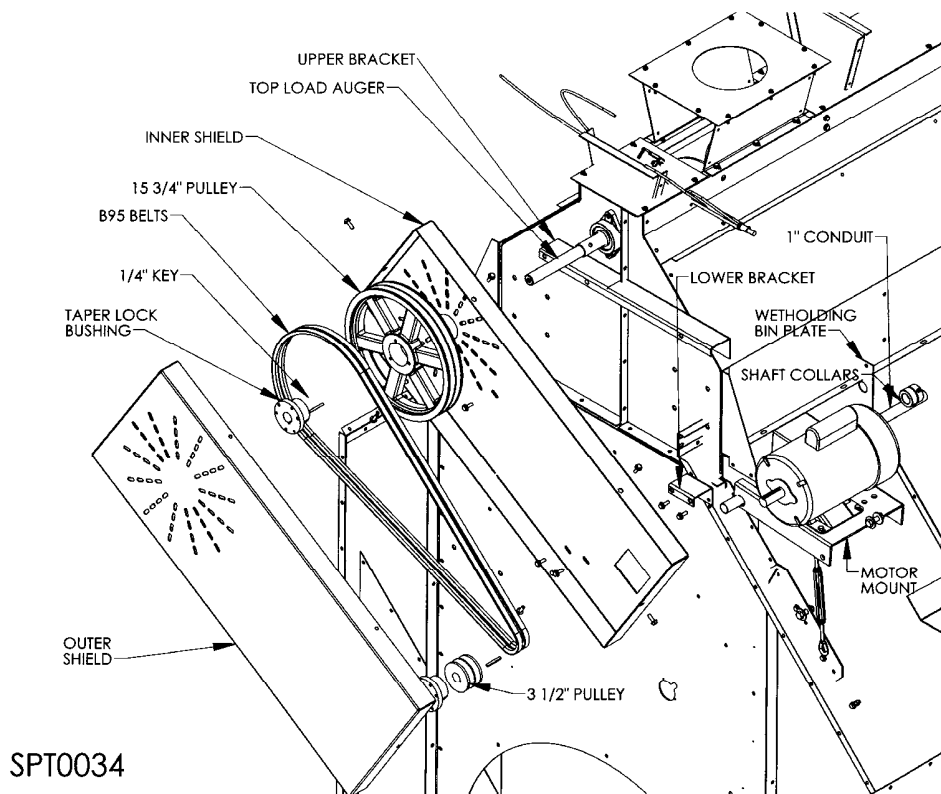

Fig. 2-15 – Top load auger components

2. Hold motor mount up to holes on side of wet holding bin. Slide a 1" conduit tube through motor plate holes of dryer. See Fig. 2-15.

Top Load Auger Motor and Shields (Continued)

3. Slide shaft collars on each side of wet holding bin plate. See Fig. 2-16.

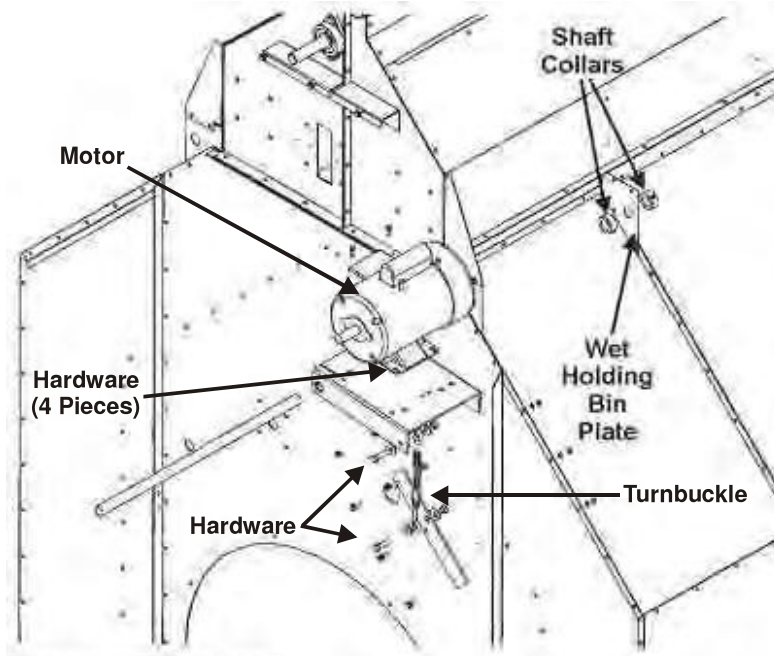

Fig. 2-16 - Motor mount components

4. Tighten shaft collars under motor mount and on each side of wet holding bin plate. Make sure motor mount can pivot. See Image 2-3.

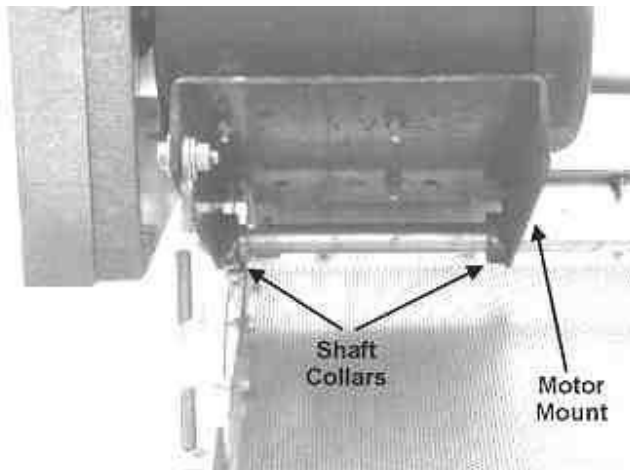

Image 2-3 – Motor mount shaft collars, installed

Top Load Auger Motor and Shields (Continued)

5. Bolt turnbuckle plate to side of dryer. See Fig. 2-16.
6. Bolt turnbuckle between motor mount and turnbuckle plate using 1/2 x 1-3/4" bolts, 1/2" flat washers and 1/2" lock nuts. See Fig. 2-16.
7. Bolt motor to motor mount using 5/16 x 1" bolts and 5/16" nuts and washers. See Fig. 2-16.
8. Bolt inner shield to upper and lower brackets using 5/16" bolts, washers, and nuts. See Fig. 2-15.
9. Attach a 3-1/2" O.D. pulley to motor shaft with a key and attach 15-3/4" O.D. pulley to top load auger with a taper lock bushing. Use straight edge to align pulleys. Attach two B95 belts between auger pulley and motor pulley. Tighten turnbuckle to tighten belts. See Fig. 2-17. Tension belts so it takes about 6 lbs. pressure to deflect belt 1/2" at center of belt span.
10. Final assembly should appear as in Fig. 2-17 (Shown without front shield).

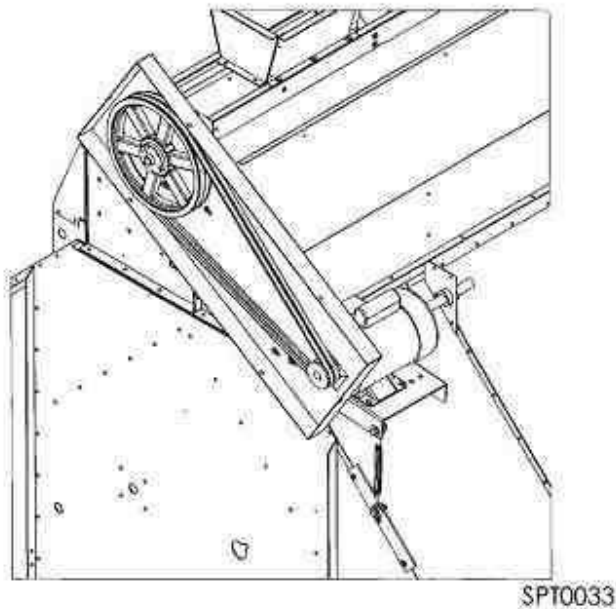

Fig. 2-17 – Final assembly (without front shield)

11. Slide outer shield around inner shield and attach with six (6) 5/16 x 1" bolts. See Fig. 2-15.